

## Flange Mounted Std. tefc motor AC Working.

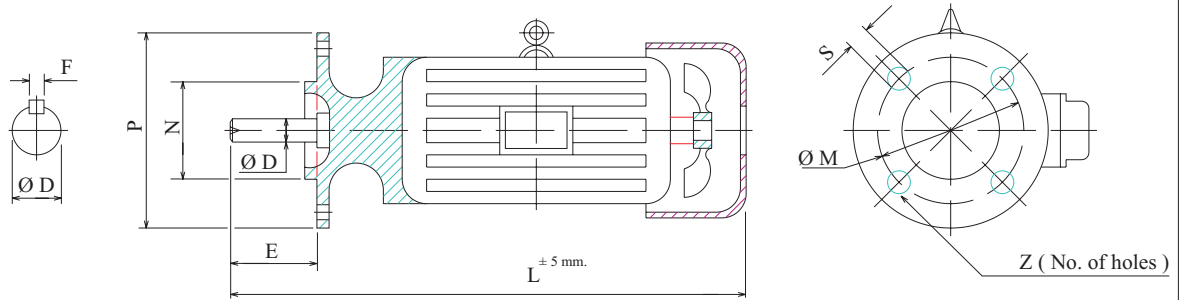

Frame size	P	N	M	E	D	F	S	Z	L
63	140	95	115	23	11	4	10	4	220
71	160	110	130	30	14	5	10	4	255
80	200	130	165	40	19	6	12	4	285
90S	200	130	165	50	24	8	12	4	315
90L	200	130	165	50	24	8	12	4	340
100L	250	180	215	60	28	8	15	4	380
112M	250	180	215	60	28	8	15	4	395
132S	300	230	265	80	38	10	15	4	455
132M	300	230	265	80	38	10	15	4	495
160M	350	250	300	110	42	12	19	4	600
160L	350	250	300	110	42	12	19	4	645

Note-1) Flange mounted motors as per IS:325 & IS:2223; with cooling fan.  
 2) All Dimensions are in mm.

Drg. No.- B-5/ TEFC / STD. / 2007 / 1009.