

CLUTCH AND BRAKE 'P' SERIES

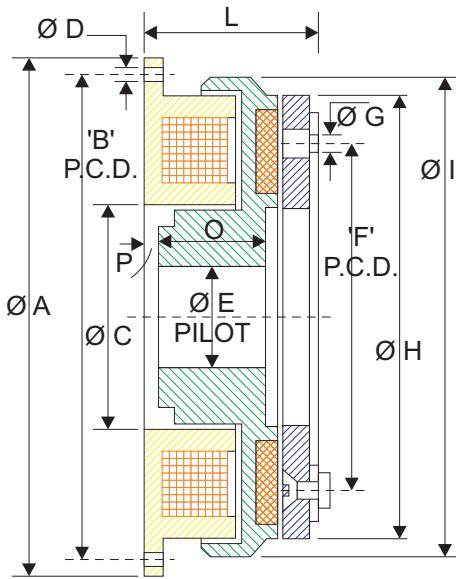

CLUTCH : C
 ARMATURE PLATE WITH
 SPRING STEEL : S.S.A.

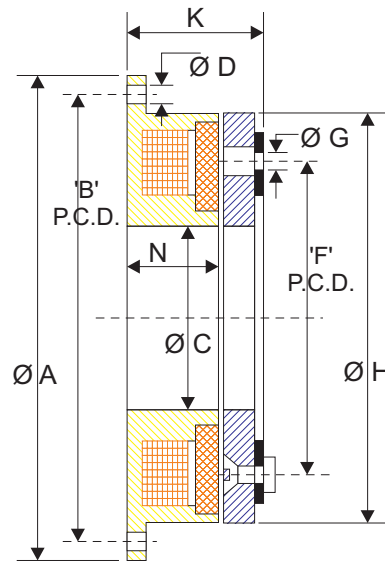

BRAKE : B
 ARMATURE PLATE WITH
 SPRING STEEL : S.S.A.

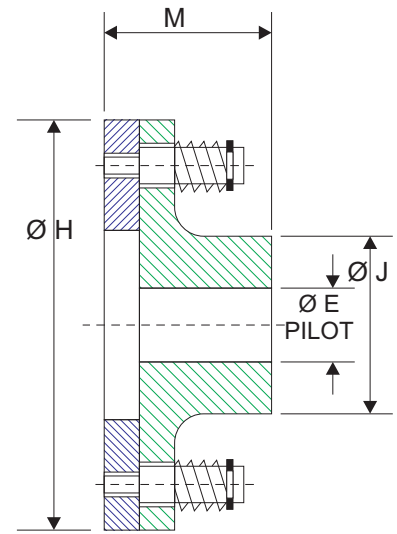

**PIN DRIVE ARMATURE
 PLATE ASSEMBLY : P.D.A.
 FOR CLUTCH AND BRAKE**

DRG. NO.: P/STD/011/99

DRG. NO.: P/STD/013/99

DRG. NO.: P/STD/014/99

MODEL	TECH DATA		DIMENSIONS															
	WATTS 24 V.DC	TORQUE KG. M.	Ø A	B PCD	Ø C	Ø D NO OFF	Ø E MAX	ARMATURE FIXING		Ø H	Ø I	Ø J	K	L	M	N	O	P
								'F' PCD	GØ X NO.									
P-45	8	0.15	60	52	18	4.3X3	10	29	4.1X2	45	45	17	21	27	18	17	22.4	2
P-63	12	0.5	80	72	35	4.5X4	17	46	4.1X3	63	68	27	22	28	20	18	22.4	2
P-80	15	1.5	100	90	42	4.5X4	22	60	4.1X3	80	85	32	25	31	25	20	24	3
P-100	20	3.0	125	112	52	6.5X4	30	76	5.1X3	100	107	42	29	36	35	22	27	3.5
P-125	35	5.0	150	137	62	6.5X4	40	95	6.1X3	125	134	49	31	41	40	24	30	4
P-160	45	10.0	190	175	80	9.0X4	50	120	8.2X3	160	170	65	35	47	50	26	34	4
P-200	50	24.0	230	215	100	9.0X4	65	158	10.2X3	200	214	85	46	56	60	30	40	4
P-250	60	35.0	290	270	125	11.0X4	80	210	12.2X4	250	266	105	50	64	70	35	47	5

- NOTE :**
- 1) ALL CLUTCHES AND BRAKES ARE WORKING ON 24 V.DC OTHER DC. VOLTAGES ARE AVAILABLE ON REQUEST AT EXTRA COST.
 - 2) WE RESERVE OUR RIGHTS TO CHANGE ANY DIMENSIONS AND TECHNICAL DETAILS DUE TO CONSTANT DEVELOPMENTS
 - 3) (i) B DENOTES FOR BRAKE (ii) C DENOTES FOR CLUTCH (iii) SSA DENOTES ARMATURE PLATE WITH SPRING STEEL. (iv) P.D.A. DENOTES ARMATURE PLATE WITH PIN DRIVE ARRANGEMENT.
 - 4) ORDERING DATA EXAMPLE P-125 C.S.S.A. IT MEAN CLUTCH ASSLY ARMATURE PLATE WITH SPRING STEEL PLATE 2) P-100 B.P.D.A. IT MEAN P-100 BRAKE ASSLY ARMATURE PLATE WITH PIN DRIVE ARRANGEMENT.